

Your Local Cancer Care

BRINGING RADIATION TREATMENT TO MOSES LAKE

\$2 Million Closer to Realizing the Vision

In 1998, Howard Gallion lost his wife, Lois, to cancer. Two years later he started what would become the Columbia Basin Cancer Foundation. His vision was very simple, to bring cancer treatment to the Columbia Basin. Today we are closer than ever to completing his vision, as more than 120 people, corporations and foundations have made gifts totaling \$2 million in support of a radiation treatment facility in Moses Lake through the *Your Local Cancer Care* campaign.

“By reaching this internal milestone to raise \$2 million by the end of 2019, we are on track to complete our \$3.5 million goal,” says Abel Noah, Confluence Health Foundation vice president and executive trustee.

“The support of our region is outstanding and will lead to tremendous improvements for cancer patients in our community,” says Angel Ledesma, executive director of the Columbia Basin Cancer Foundation.

These donors include conscientious people from throughout the Columbia Basin. They also include our partners in Wenatchee. Confluence Health, Wenatchee Valley Medical Group, Confluence Health Foundation with each of these organizations' boards and administrators have pledged more than \$1 million to the effort.

The Columbia Basin Cancer Foundation, Confluence Health and the Confluence Health Foundation are all nonprofit organizations, which means every gift made to the *Your Local Cancer Care* campaign is eligible for tax deductions. These nonprofits are leading the way as Howard's vision becomes reality.

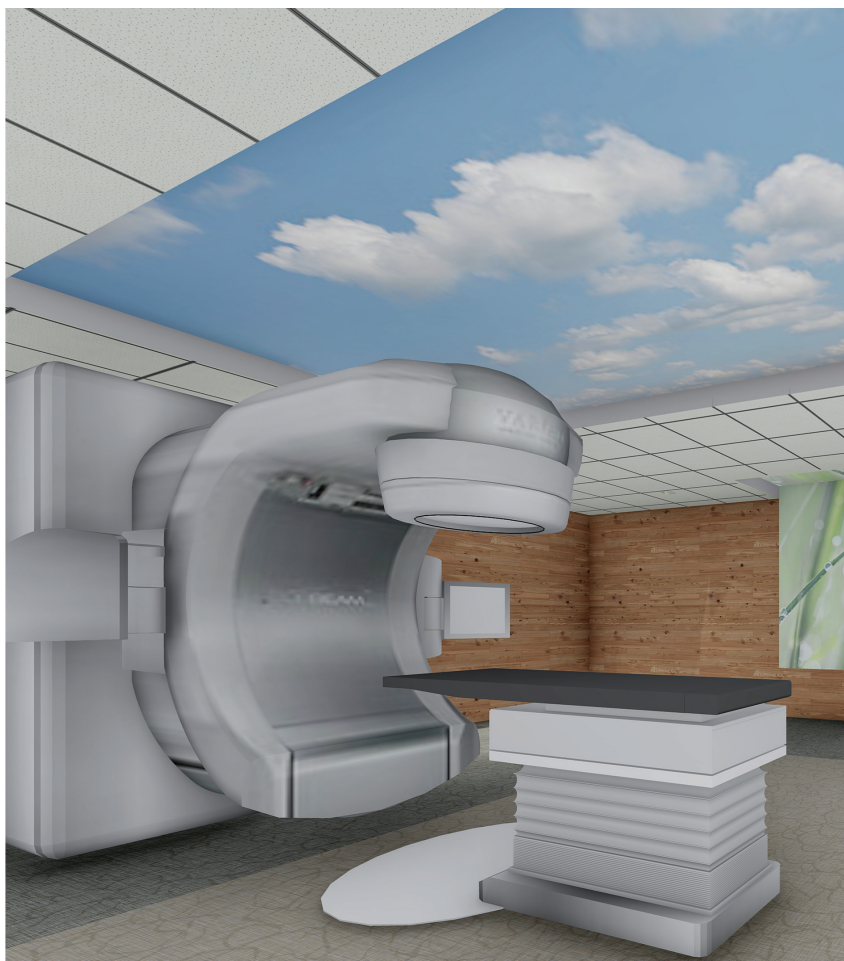

DID YOU KNOW?

60% of cancer incidences will need radiation treatment, according to radiation oncologists.

The Cancer Commute

The Columbia Basin is a beautiful region to call home. Its rich soil, natural resources and physical beauty account for some of the reasons people love living here. Another is its simple lifestyle. Neighbors know each another. Families and friends support one another. And when someone needs help, the community rallies to their support.

This is Columbia Basin Cancer Foundation’s heritage – giving cancer patients and their loved ones the support they need to survive. To date, that support was limited to helping people cope with fighting cancer, as many patients needing radiation treatment travel for hours to Confluence Health in Wenatchee or another cancer center in Seattle, Spokane or the Tri-Cities.

This commute has been one of the few downsides to living in the Columbia Basin; it is long, treacherous in bad weather, and exhausting for patients and their loved ones. The region has been too small to support a radiation treatment center. However, with the help of Confluence Health physicians and staff, the Moses Lake Clinic is positioned to build a state-of-the-art radiation treatment facility, including a linear accelerator that can administer the latest treatment protocols.

“The *Your Local Cancer Care* capital campaign will end the cancer commute for hundreds of Columbia Basin residents every year, making this beautiful region in central Washington an ever-better place to live,” Columbia Basin Cancer Foundation Executive Director Angel Lesdesma says.

Cancer Incidences by County and Expected Growth

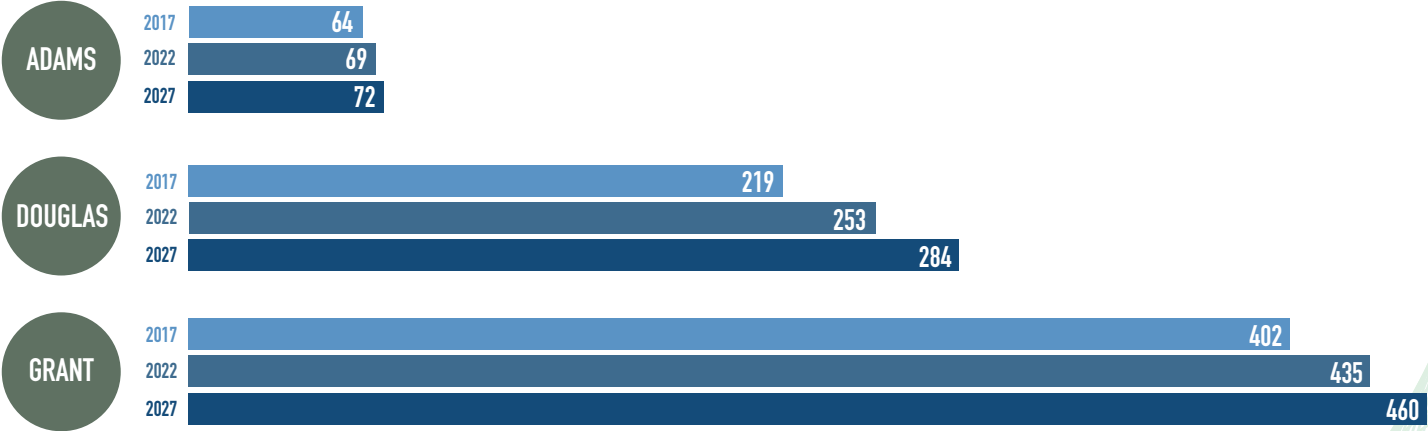

Project Scope

- 1 Provide local radiation oncology services for patients and their caregivers in the Columbia Basin
- 2 Bring state-of-the-art radiation treatment protocols to the Columbia Basin in a cost-effective, self-sustaining model of care
- 3 Grow CBCF’s mission to include more local support services to cancer patients



Confluence Health Foundation
518 N. Chelan Ave.
Wenatchee, WA 98801
509.665.6030



**COLUMBIA BASIN
CANCER FOUNDATION**

Columbia Basin Cancer Foundation
1031 W. Broadway Ave.
Moses Lake, WA 98837
509.764.4644